

DALI Decoder

LC-0RGB-D4-06

Features:

DALI(Digital Addressable Lighting Interface), which is the commonly used lighting control system in the industry, has the function of all lights dimming, group dimming, addressable dimming, multiple modes setting, brightness check, fault feedback, etc. DALI standard is widely used as its feature of simple, reliable, function good, etc. This product can be compatible with latest version of DALI standard as IEC62386, can control any DALI standard device which is connected in the same bus. Note: When DALI controller's power consumption is not enough for use, can connect with amplifiers to enlarge the power.

Technical parameter:

Input voltage:DC12-24V
Output Max. Current:5A for each channel(3 channels)
Output Max. Power:180W(DC12V),360W(DC24V)
Output signal type:PWM
Working temperature:-30℃-55℃
Weight:116.4g
Package size:153*101*54mm



Dimensions (Unit: mm/inch)

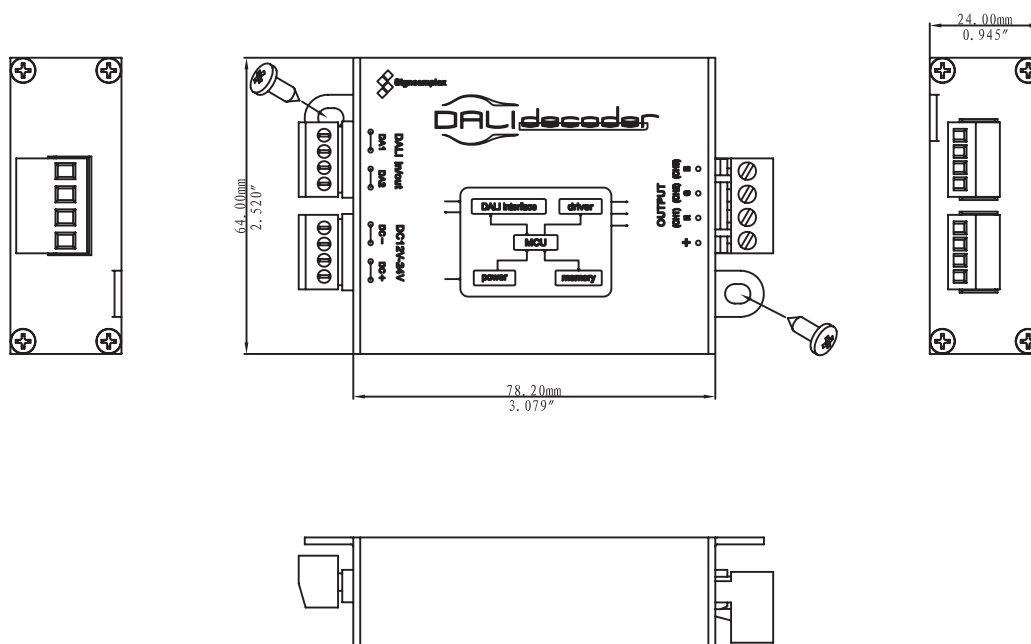

Technical parameter:

- Step 1: Connect 2 DALI bus lines separately with DA1, DA2(DALI IN/OUT).
- Step 2: Connect it with lights. Connect controller+port(OUTPUT) to the anode of light. Connect one of CH1,CH2 or CH3 of controller to the cathode of light.
- Step 3: Connect DC+(POWER) with anode, DC-(POWER) with cathode. The voltage should in the proper range and pay attention to the sequence of anode and cathode port, inappropriate connection may burn the controller.
- Step 4: Set corresponding dimming figures in the DALI control system.

Wiring diagram:

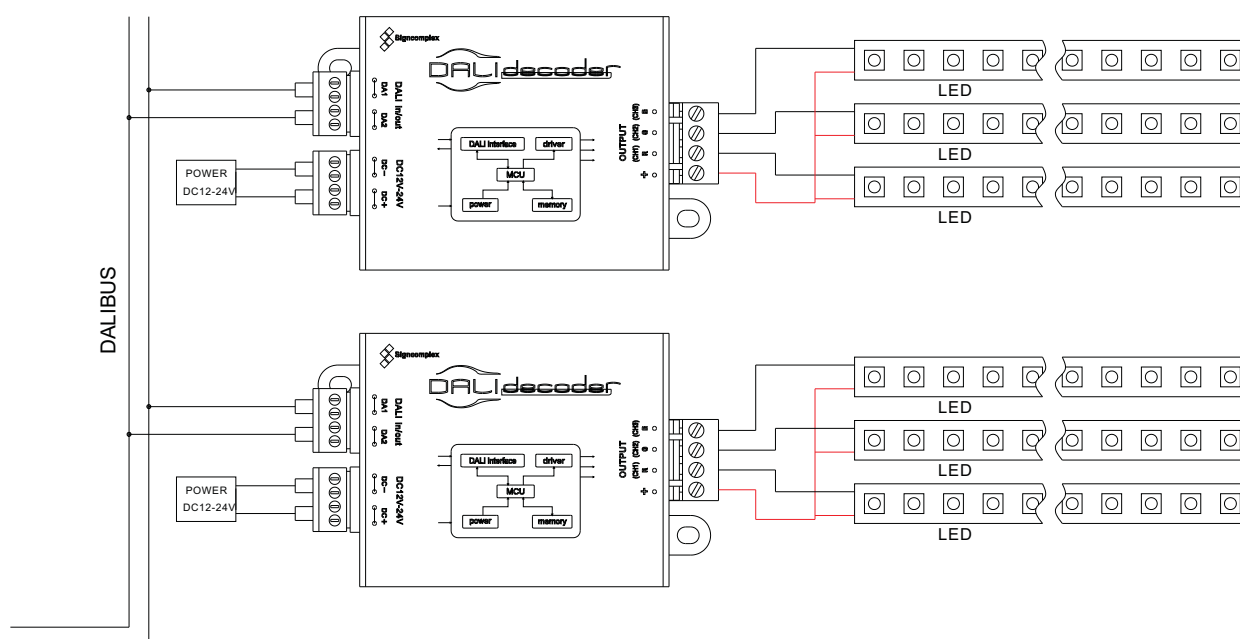

Warnings:

- 1.For RGB 3 channels, each channel's current should not be over 5A, so as not to burn out the controller.
- 2.Connect wires according to the wiring diagram, the line sequence should not be reversed.
- 3.Please use DC 12/24V as the power supply of controller, DO NOT use civil high voltage power directly.