



LED Grille Lamp-C

SC-GL-45-AW-01CW-C

SC-GL-45-AW-01NW-C

SC-GL-45-AW-01WW-C

Description

New LED Troffer has the feature of high luminous efficiency, energy saving and long-life span, can replace LED Tube. Application: Hotels, meeting rooms, factories, offices, supermarkets, residential areas, schools, hospitals and other places which need high color rendering index.

Features

1. Color: cool white(5500-6500K), nature white(3900-4500K) warm white(2700-3200K), other available.
2. Beam angle: 110°
3. Saving energy: 50%
4. Life span more than 50,000Hrs
5. IP code: Ip40
6. Standard warranty: 3years
7. Follow RoHS and CE Certified.

Technical Parameter

Input Voltage: AC100-240V 50-60Hz
Max Current: 0.80A
LED type: 2835 SMD LED
Output Power: 45W
Reflector: frosted cover
Net weight: 2.8KG
Gross weight: 6.67KG(2PCS)
Inner box size: 660*650*310mm (6PCS per box)



Applications

- Hotels
- Conference/Meeting rooms
- Factories and offices
- Commercial purposes
- Residential / Institution buildings
- Schools, colleges, universities and hospitals
- Places which needs energy saving and high color rendering index lighting.





Specifications

Model #	CCT	LED Type	Lumen(lm) (±10%)	CRI	Beam angle	Power(W) (±10%)	Voltage (V)	PF	Weight (Kg)
SC-GL-45-AW-01CW-C	5500-6500K	2835	3908lm	>80	/	45W	AC100-240V 50-60Hz	/	2.8
SC-GL-45-AW-01NW-C	3900-4500K		3900lm	>80	/	45W			
SC-GL-45-AW-01WW-C	2700-3200K		3590lm	>80	/	45W			

Dimensions (Unit: mm)

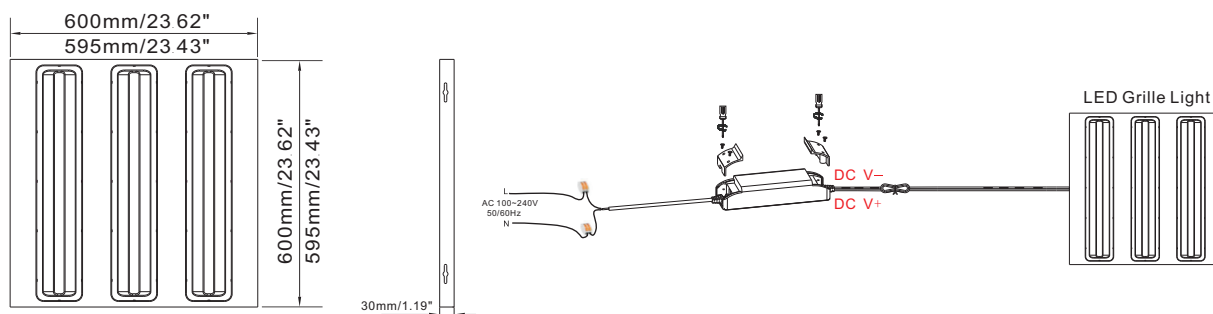

How to fix

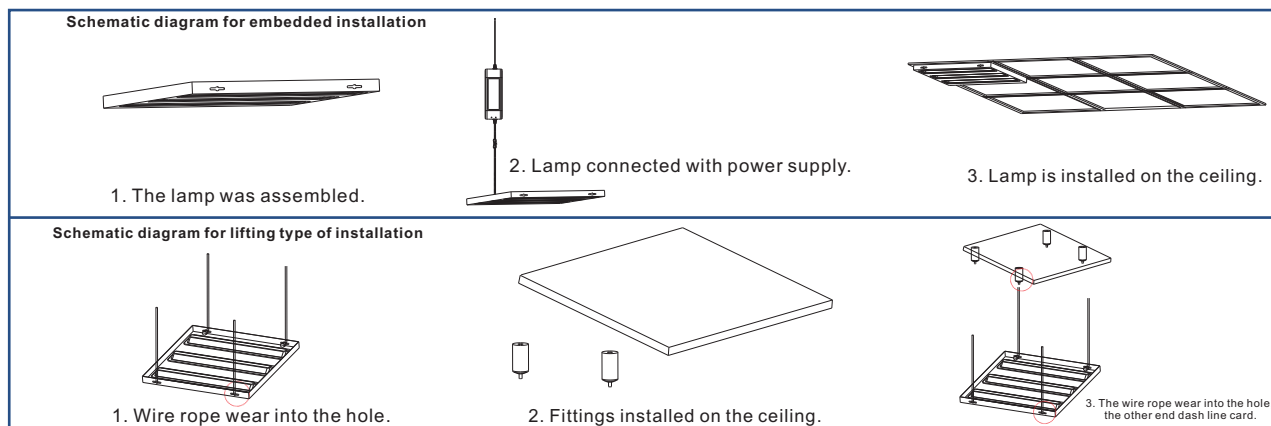

! Notice

1. Please read the specification first, to make sure the service environment matches the condition in the specification before using.
2. Please confirm the applicable power supply before using.
3. Make sure the switch of product is off before connect to the power supply to prevent electric shock.
4. Operation against rules may damage your property even harm to your personal safety.
5. Preliminarily estimate required quantity of LED flood lights, then according to the power rating of single flood light to figure out the total power and design power supply plan.
6. Dangerous high voltage, Non-professionals are not allowed to maintain the products.
7. If the exterior flexible cable or wire is damaged, it must exchange by the supplier, its agent or other similar qualified personnels to avoid dangers.